

# Articulated feet

base in reinforced polyamide

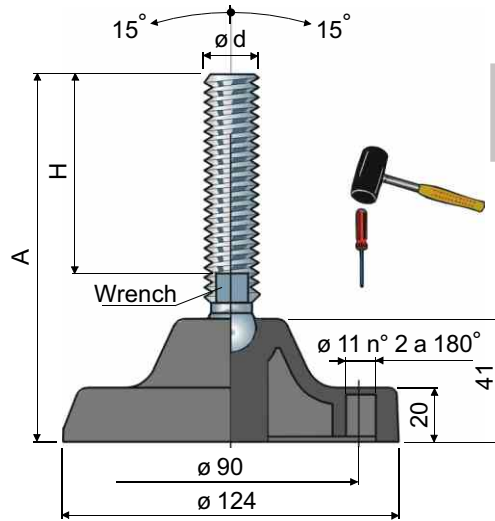

**Ø 124 Part.92**

ø d	A mm	H mm	Wrench mm	Spindle in zinc plated steel	Spindle in stainless steel AISI 304	Max static load N
				Code/Codice	Code/Codice	
M16	120	60	13	92 / 7782	92 / 7783	25000
	150	90	13	92 / 7784	92 / 7785	
	165	105	13	92 / 7786	92 / 7787	
	185	125	13	92 / 7788	92 / 7789	
	215	155	13	92 / 7790	92 / 7791	
	225	165	13	92 / 7792	92 / 7793	
M20	149	86	17	92 / 7794	92 / 7795	27000
	179	116	17	92 / 7796	92 / 7797	
	204	141	17	92 / 7798	92 / 7799	
	269	206	17	92 / 7800	92 / 7801	
M24	159	96	19	92 / 80702	92 / 80703	29000
	185	122	19	92 / 80704	92 / 80705	
	215	152	19	92 / 80706	92 / 80707	
	245	182	19	92 / 80708	92 / 80709	
	363	300	19	92 / 80710	92 / 80711	

**Base material:** reinforced polyamide.  
**Packaging:** 8 pieces.

## Accessories

### Anti-slip pads:

- code: 7633;
- material: PVC rubber (black);
- packaging: 8 pieces.

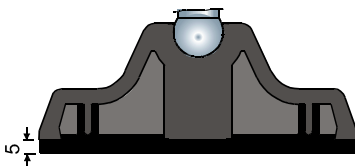

### Nuts UNI 5588-65 - Packaging: 24 pieces.

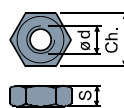

ø d	M16	M20	M24
Smm	13	16	19
Ch. mm	24	30	36
Zinc plated steel code	7275	7276	7279
Stainless steel code	7277	7278	7280

### Washers UNI 6592-69 - Packaging: 24 pieces.

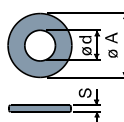

ø d mm	17	21	25
Smm	3	3	4
ø A mm	30	37	44
Zinc plated steel code	7289	7290	7293
Stainless steel code	7291	7292	7294

## On request

- Bases:** In reinforced polypropylene • other colours • with prebored fixing holes.
- Spindles with:** Sunk hexagon head • second wrench seat head • hexagon wrench seat • threads with other pitches and lengths.
- Packaging:** not standard.
- Assembling of:** Anti-slip pads • nuts • washers.